

# **Nakuru Summit**

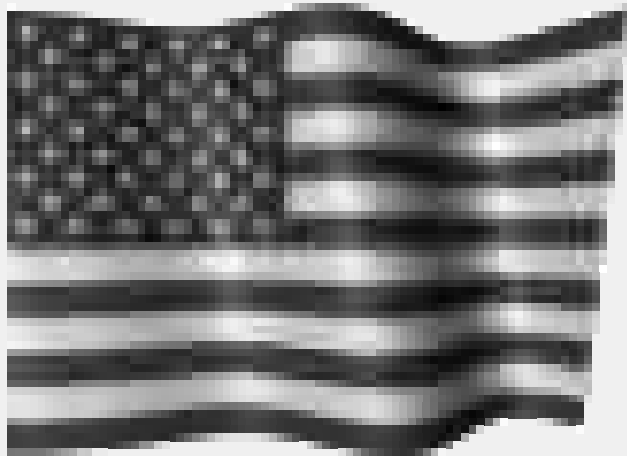

## **Orphanage Mission Break Out Session**

Smyrna Presbyterian Church

Conyers, Georgia USA

October 27, 2007

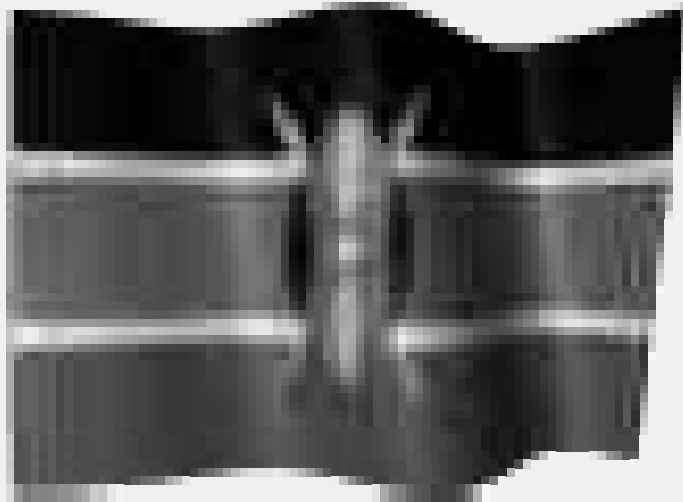

# K e n y a

About Kenya Last updated: August 2007  
(source - [www.dfid.gov.uk](http://www.dfid.gov.uk))

**National absolute poverty has declined from 52.3% in 1997 to 45.9% in 2005/06 but inequality remains high. 1 in 5 Kenyans have consumption levels that are inadequate to meet basic food needs.**

# Kenya

About Kenya Last updated: August 2007

**The economy has been growing steadily over the last three years (4.9% in 2004, 5.8% in 2005 and 6.1% in 2006), but it is not yet sufficient to make rapid progress in reducing poverty.**

# K e n y a

About Kenya Last updated: August 2007

**The Government still faces major political and economic challenges including ethnic divisions, weak and corrupt institutions and a run-down infrastructure. A General Election will be held in December 2007.**

# K e n y a

About Kenya Last updated: August 2007

**Population of 34.5m.**

**Life expectancy is 45 years.**

**More than 1 in 10 children dies  
before their fifth birthday.**

# K e n y a

About Kenya Last updated: August 2007

**Just under 6% of the adult population lives with HIV/AIDS (about 1.3 million people). In the UK the number is around 60,000..**

# K e n y a

(source – Stephen Lewis Foundation)

**1.1 million children in Kenya have been orphaned by AIDS.**

**In total there are 2.4 million orphans in Kenya.**

**Nearly 60% of the population is living on less than \$2 per day.**

# K e n y a

(source – Stephen Lewis Foundation)

**More than 1.3 million Kenyans are living with HIV.**

**150,000 children are living with HIV.**

**Nearly 60% of the population is living on less than \$2 per day.**



# Nakuru West PCEA, Nakuru Kenya

**Nakuru West has long been a church mission minded in its own community**

- **Pre School**
- **Primary School**
- **Health Clinic**
- **Job Training**
- **Maternity Center**
- **Orphanage**

# The Vision of Tumaini (Hope)

- Home for 400 Children
- School for 800 primary and secondary students
- Chapel for worship
- Clinic
- Conference Center

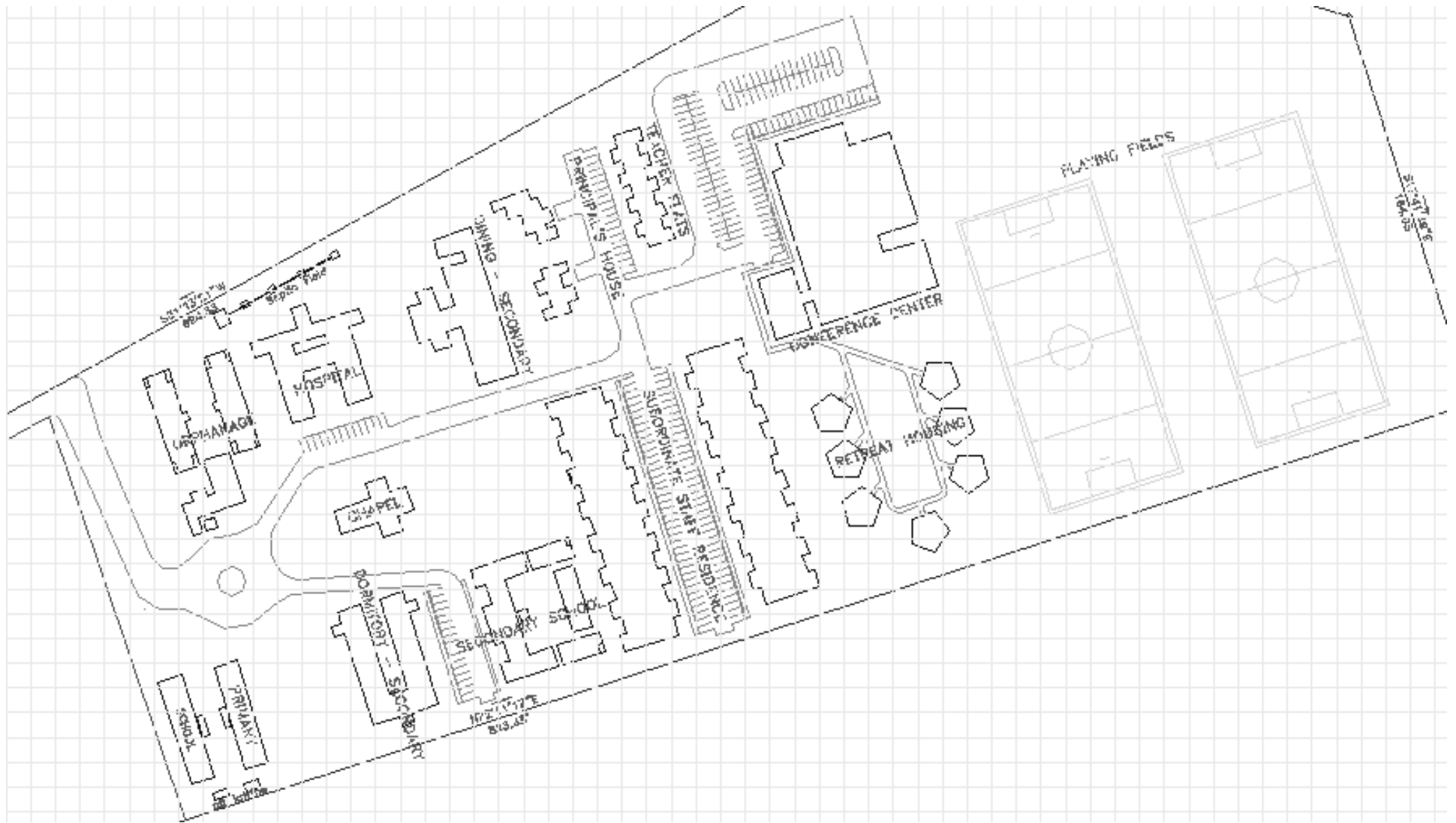

**Tumaini Mission Center and Bethany Children's Home**

# Current Status

There are sixty one children currently living at the Bethany Children's home.

There will be housing available for 100 children, January 2008.

# Education is Emphasized

- HIV infection rates are at least twice as high among young people who do not finish primary school as those who do.
- Government schools have a student teacher ration of 90 to 1. Jitegemea schools have a ratio of 35 to 1.

# Education is Emphasized

- **The orphaned children attend school with other children in the community**

# Education is Emphasized

- **In school, the orphaned children are equals to the children who have parents. You cannot tell them apart.**

# Local Support

**Nakuru West PCEA members are dedicated to the children.**

- Mentoring
- Prayers
- Check on schooling
- Visits
- Finding out needs of the Children.

# All Needs are Met

- Nutrition
- Medical needs
- Clothing
- School supplies
- Education
- Spiritual needs
- Clean housing
- A loving environment

# Efforts to Self Sustain

- School
- Farming
- Sale of water
- Future conference center

# Why is Your Help Effective at Tumaini ?

- Nakuru West Team has ownership
- Your visit is more important than your money
- Language is not a barrier
- Kenya is open to outside help
- The need is great, conditions improving
- Volunteer based, no overhead to support
- **God is at work at Tumaini and wants you to join Him**

# How You Can Help?

- GO TO KENYA AND VISIT THE CHILDREN

- SPONSER A CHILD, \$500 per year covers food, housing, medical needs, education in a Christian School, school supplies, clean water, a clean home and a loving environment

- Raise Funds, a \$350,000 matching fund has been established, your fund raising goes 2x further.

## Matching Funds

Did I mention that there is a generous gift of \$350,000 that will match dollar for dollar every donation that is made to the Tumaini Mission Center?

# **Tumaini Mission Center**

## **A Model for other Kenya Communities**

---

- Ownership by Kenyans
- Education Emphasized
- Christian Environment
- US Church Based Support
- Self Sustaining Goals

**Bwana  
Asifiwe!!**